

Z534 12-1/4" DIAMETER HEAVY-DUTY PARKING DECK DRAIN WITH SUPPORT FLANGE



ENGINEERING SPECIFICATION

Zurn Z534 12-1/4" diameter parking deck drain features Dura-Coated cast iron body with bottom outlet, heavy-duty, gasketed drain support flange with heavy-duty, slotted grate.

NOTES

†Add 3/16" to 2" dimension and 3/4" to 12-1/4" dimension for ZB and ZN

A Pipe Size inch [mm]	Grate Open Area sq in [cm ²]	Approximate Weight lb [kg]
2 [51], 3 [76], 4 [102], 6 [152]	30 [194]	78 [35]
8 [203]		80 [36]

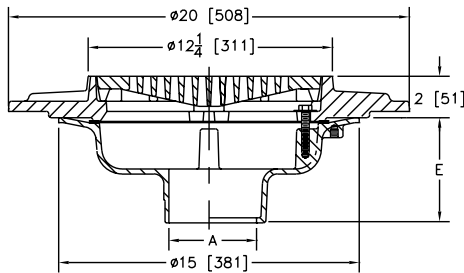

BEST SELLERS	LIST PRICE
ZB534-3NH-HP-VP	3,748.00
Z534-4NH	2,522.00
Z534-4NH-C	2,766.00
Z534-4NH-C-HP-TS	2,895.00
Z534-4NH-C-HP-Y	2,972.00
Z534-4NH-C-Y	2,972.00
Z534-4NH-HP-SA-Y	2,836.00
Z534-4NH-HP-TS-Y	2,857.00
Z534-4NH-HP-Y	2,728.00
Z534-4NH-VP	2,671.00

PREFIXES	DESCRIPTION	PIPE SIZE	LIST PRICE
Z534*	D.C.C.I. Body and Top	2", 3", 4", 6"	2,522.00
		8"	2,823.00
ZB534	D.C.C.I. Body with Polished Bronze Top	2", 3", 4", 6"	3,599.00
		8"	3,900.00
ZN534	D.C.C.I. Body with Polished Nickel Bronze Top	2", 3", 4", 6"	3,824.00
		8"	4,131.00

OUTLETS (SPECIFY PIPE SIZE IN INCHES AND TYPE OF OUTLET)				
OUTLET TYPE		PIPE SIZE/OUTLET TYPE	E BODY HT. DIM.	ADD
IC	Inside Caulk	3IC, 4IC, 6IC	5-1/4"	N/C
IG	Inside Gasket	3IG, 4IG, 6IG	5-1/4"	N/C
IP	Threaded	2IP, 3IP, 4IP, 6IP, 8IP	3-3/4"	80.00
NH	No-Hub	2NH, 3NH, 4NH, 6NH, 8NH	5-1/4"	N/C
NL	Neo-Loc	2NL, 3NL, 4NL	4-5/8"	N/C

SUFFIXES		ADD
-C	Underdeck Clamp	244.00
-G	Galvanized Cast Iron	1,093.00
-HP	Heel-Proof Grate	N/C
Ⓢ -SA	Stabilizer Assembly (See Z1036)	148.00
Ⓢ -TC	Neo-Loc Test Cap Gasket (2", 3", 4" NL Bottom Outlet Only)	24.00
-TS	Top Secured with Slotted Screws	129.00
-VP	Vandal-Proof Secured Top	149.00
-XJ	Expansion Joint (Use with IP Type Outlet) (See Z190)	-
-Y	Sediment Bucket	206.00

BEST SELLERS	LIST PRICE
Z534-4NL	2,522.00
Z534-4NL-C	2,766.00
ZN534-4NL	3,824.00
Z534-6NH	2,522.00
Z534-6NH-HP-TS	2,651.00
Z534-6NH-VP-Y	2,877.00
Z534-8NH	2,823.00

Z535 HEAVY-DUTY PARKING STRUCTURE DRAIN



ENGINEERING SPECIFICATION

Zurn Z535 square top, heavy-duty drain features oven-cured acid resistant epoxy-coated aluminum or cast iron body with bottom outlet, top membrane clamping collar, anti-ponding slots, sediment bucket and heavy-duty, anti-tilt, hinged, slotted grate with stainless steel hinge pins.

A Pipe Size inch [mm]	Grate Open Area sq in [cm ²]	Approximate Weight lb [kg]
3 [76], 4 [102], 6 [152], 8 [203]	56 [361]	29 [13] for aluminum, 75 [34] for cast iron

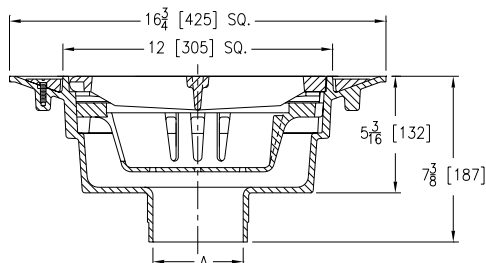

PREFIXES	DESCRIPTION	PIPE SIZE	LIST PRICE
Z535*	A.R.C. Aluminum Body and Top	3", 4", 6", 8"	3,843.00
ZC535	D.C.C.I. Body and Top	3", 4", 6", 8"	3,843.00

OUTLETS (SPECIFY PIPE SIZE IN INCHES AND TYPE OF OUTLET)			
OUTLET TYPE	PIPE SIZE/OUTLET TYPE	ADD	
NH	No-Hub	3NH, 4NH, 6NH, 8NH	N/C

SUFFIXES		ADD
-CI	Cast Iron Grate	462.00
-L	Locking Device	138.00

BEST SELLERS	LIST PRICE
Z535-3NH	3,843.00
Z535-4NH	3,843.00
Z535-6NH	3,843.00

*Regularly furnished unless otherwise specified.

Items designated as Best Sellers are most specified and are generally in stock for shipment.

Ⓢ This symbol denotes a product that is engineered to reduce installation and rework time.

For additional product information, please visit www.zurn.com

INTRO
 ROOF DRAINS
 FLOOR DRAINS
 T, P, BW VALVES
 INTERCEPTORS
 CARRIERS
 HYDRANTS
 CLEANOUTS
 W/HA
 SS DRAINS
 FAB SS DRAINS
 SAN-FLOOR
 TECH INFO